

- 1 - TOP HINGE ASSEMBLY
- 2 - BOTTOM HINGE ASSEMBLY
- 3 - 1/8" CLEAR LEXAN FACE PANEL
- 4 - 1 1/2" SQUARE TUBULAR STEEL DOOR FRAME
- 5 - 11 ga. ROLL-FORMED STEEL SIDE FRAME
- 6 - PVC EDGE TRIM C/W GASKET

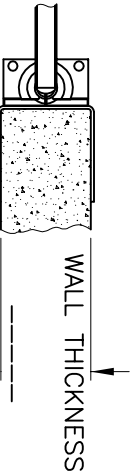

EXTENSION "U" BRACKET

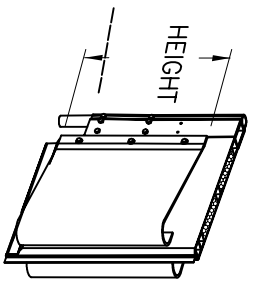
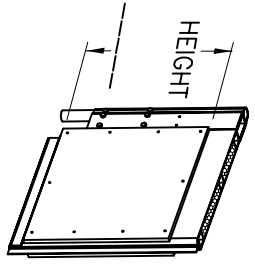
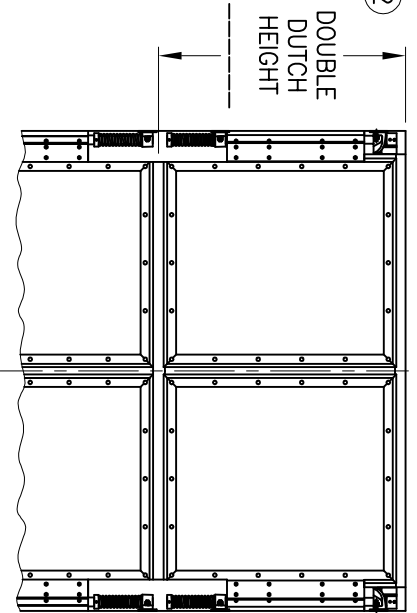

DOUBLE DUTCH

DOOR OPENING:

_____ W x _____ H

DOUBLE SINGLE

QUANTITY = _____

COLOR = _____

OPTIONS

(CHECK BOX IF APPLICABLE)

- DOUBLE DUTCH

- 1/2" CLEAR LEXAN

- SPRING BUMPERS (UP TO 48"H)

- CHAIN LOCKING COLLAR

- EXTENSION "U" BRACKETS

WALL TYPE = _____

CURBS / OBSTRUCTIONS ?

YES NO

- HOLD OPEN DEVICE

- 90-135° WIDE ANGLE HINGE

- DOOR STOP

- 12" TOP CANE BOLT ASSEMBLY

- 46" BOTTOM CANE BOLT

ASSEMBLY

- PROTECTIVE BOLLARDS

24" 36"

- FOR USE IN REG. ESTABLISHMENT

*** RECOMMENDED FRAMING REQUIREMENTS:
1/4" THICK x 8" WIDE FACE STEEL FRAME MOUNTED TO A SOLID FOUNDATION.



S. S. QUOTE REF. # _____
 CUSTOMER _____
 APPROVED BY: _____
 P/O No.: _____
 DATE: _____

SERIES 4500 - MODEL 4504
 HEAVY DUTY RIGID INSULATED IMPACT DOOR
 DATE: NOV-23-04 SCALE: 1:32
 DRAWN: GK,OC DWG NO: L4504-A