

OPENING WIDTH

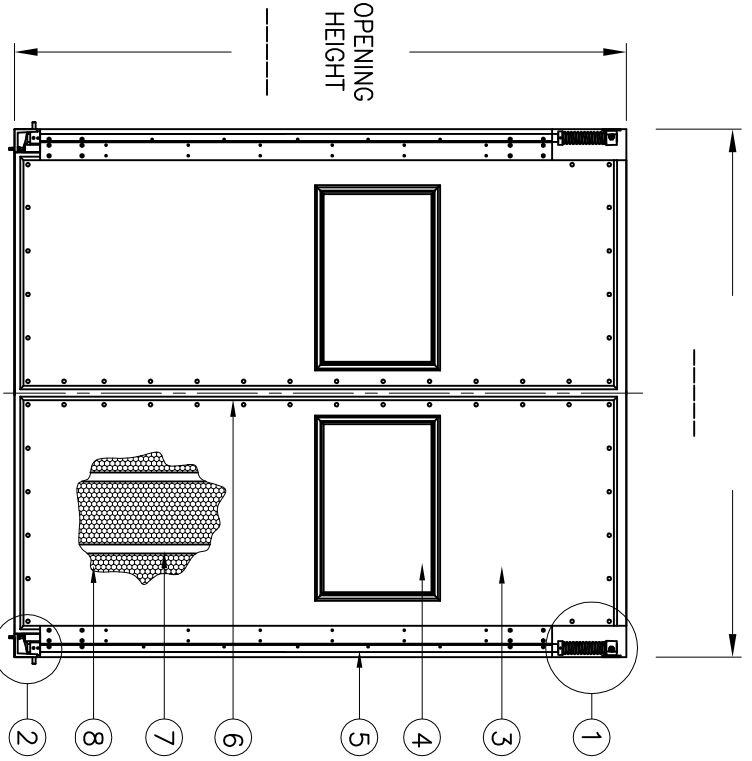

- 1 - TOP HINGE ASSEMBLY
- 2 - BOTTOM HINGE ASSEMBLY
- 3 - 1/8" THICK "TUFF PLUS" COLOR FACE PANEL
- 4 - 1/8" THICK SEALED DOUBLE THERMOPLANE SAFETY WINDOW (WINDOW SIZE VARIES DEPENDING ON DOOR SIZE) (CONSULT FACTORY)
- 5 - 11 ga. ROLL-FORMED STEEL SIDE FRAME
- 6 - PVC EDGE TRIM C/W GASKET
- 7 - 1 1/2" SQUARE TUBULAR STEEL DOOR FRAME
- 8 - 1 1/2" THICK URETHANE FOAM INSULATION

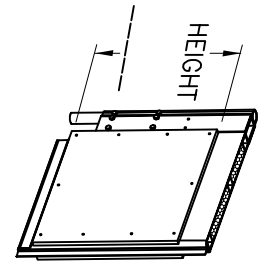

KICKPLATE

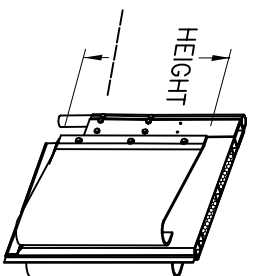

SPRING BUMPER

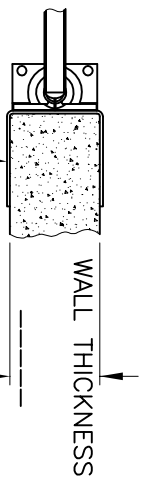

EXTENSION 'U' BRACKET

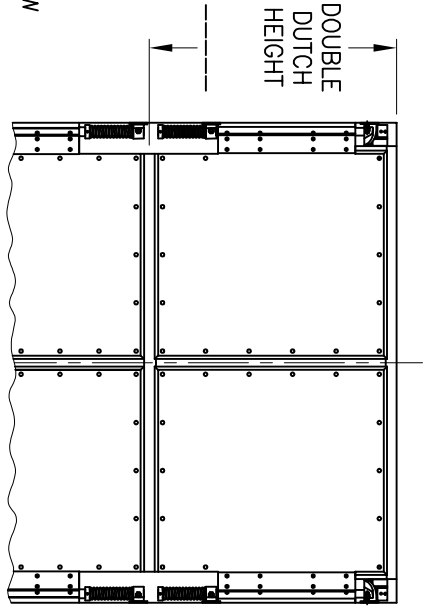

DOUBLE DUTCH

DOOR OPENING:

_____ W x _____ H

- DOUBLE SINGLE
- QUANTITY = _____
- COLOR = _____

OPTIONS

(CHECK BOX IF APPLICABLE)

- DOUBLE DUTCH
- 5/16" THICK HDP SPRING BUMPERS (UP TO 42" HIGH)
- 1/2" THICK RUBBER KICKPLATES (UP TO 48" HIGH)
- CHAIN LOCKING COLLAR
- EXTENSION "U" BRACKETS
- WALL TYPE = _____
- CURBS / OBSTRUCTIONS ? YES NO
- HOLD OPEN DEVICE
- 90°-135° WIDE ANGLE HINGE
- DOOR STOP
- 12" TOP CANE BOLT ASSEMBLY
- 46" BOTTOM CANE BOLT ASSEMBLY
- PROTECTIVE BOLLARDS 24" 36"
- FOR USE IN REGISTERED ESTABLISHMENT
- FREEZER APPLICATION FACING
- ALUMINUM GALVANIZED STAINLESS

*** RECOMMENDED FRAMING REQUIREMENTS:
 1/4" THICK x 8" WIDE FACE STEEL FRAME MOUNTED TO A SOLID FOUNDATION.

S.S. QUOTE REF. # _____
 CUSTOMER _____
 APPROVED BY: _____
 P/O No.: _____
 DATE: _____



SERIES 4500 - MODEL 4502
 HEAVY DUTY RIGID INSULATED IMPACT DOOR
 DATE: NOV-22-04 SCALE: 1:32
 DRAWN: GK, OC DWG NO: L4502-A